

# VESENKA/BLACK POND

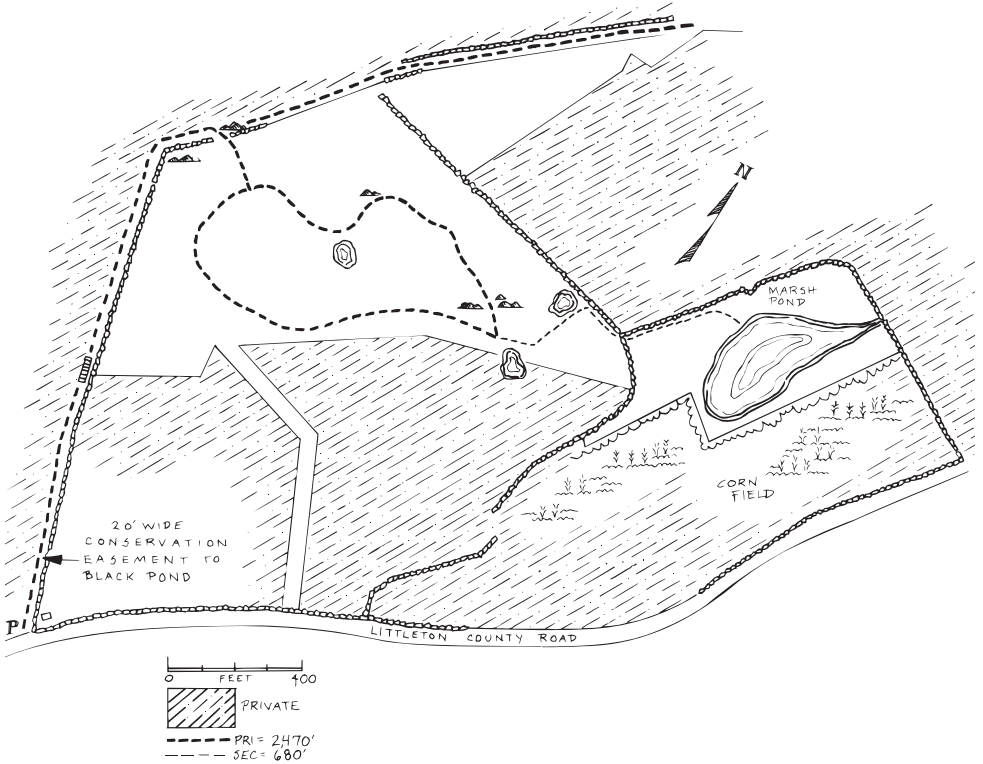

The 24.5 acre Vesenka land was purchased by the Commission in 1999. The land is accessed on a secondary trail which starts off the easement trail leading to Black Pond. The Vesenka trail passes through hardwoods and by several vernal pools. Vernal pools are temporary bodies of fresh water which provide crucial habitat to several vertebrate and many invertebrate species. Vernal pools contain many organisms, such as salamanders, wood frogs and fairy shrimp, that are unable to complete their life cycles without this habitat. On the way to the pond the terrain becomes more rugged passing by and through stone walls. There is swamp white oak and cranberry growing along the edges of the pond which is known as Marsh Pond.

Moderate