

SPRAGUE LAND

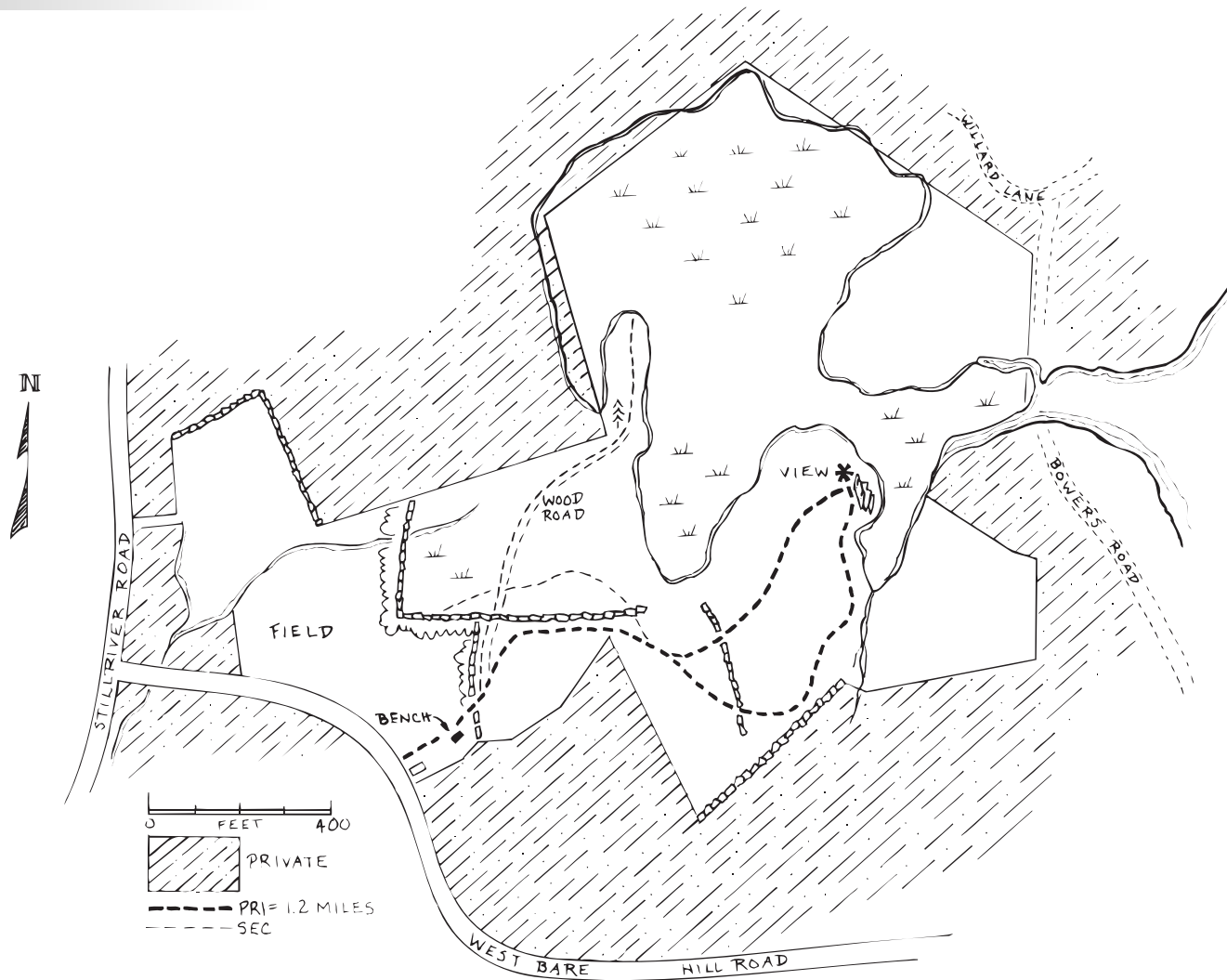

Within Still River there are some outstanding views of Mount Wachusett and the southern New Hampshire mountains. One of the best vantage points is from a beautiful field, acquired by the Commission from Morrill Sprague in 1981. In 1998 an additional 63 acres stretching back to Bare Hill Pond were purchased. The land abuts other conservation lands for a combined total of 171 acres. This holding beautifully maintains both the agricultural and natural character of Still River.

The trail passes through the open fields currently leased for crops. Please respect the local farmer. At the edge of the woods there is a granite bench sited to the view. The trail then leads into the woodlands following an old wood road. From here one section heads off through uplands to an escarpment overlooking Bare Hill Pond and then winds back to the main trail. Another section follows the old wood road to a large white pine and a secondary trail leading to the edge of wetlands by the pond.

Approx. walking time main trail: 1 1/4 hrs. - moderate